



TSR1

2.0 TCL Roku TV Wireless Soundbar

Quick Start Guide



1

Register Your Product

Register your TCL Roku TV Wireless Soundbar to receive the latest news on product releases, promotional offers, and more!*

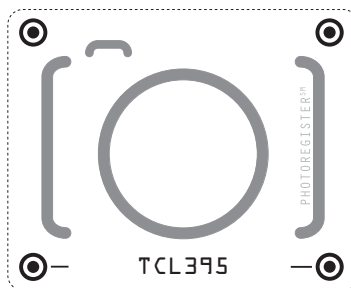

Text to Register

Text a photo of the camera icon to 71403

Or register online at register.tcl.com

Need help? Visit photoregister.com/help or text HELP to 71403

Enjoy exclusive benefits with registration:



Expedited support and service



Insider tips on your soundbar



Exclusive offers and promotions



Verification of ownership

*Only Available to U.S. Customers

2

What's in the box

Make sure you read all the safety information before you use this product.

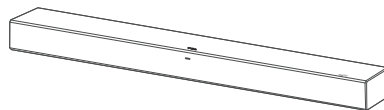

Soundbar

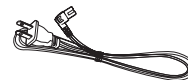

AC power cord

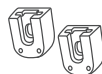

Wall mount bracket x 2



Wall bracket screw x 2



Wall anchor x 2



Wall mounting screw x 2

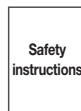

Safety leaflet



Quick Start Guide

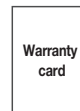

Warranty card

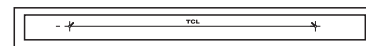

Wall mount template

① AC input power connector**② Reset button**

- Short press for restart.
- Long press for about 10 seconds for factory reset.

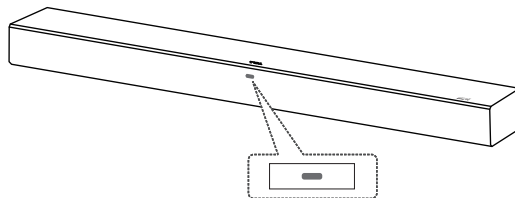

LED light:
LED Indicator

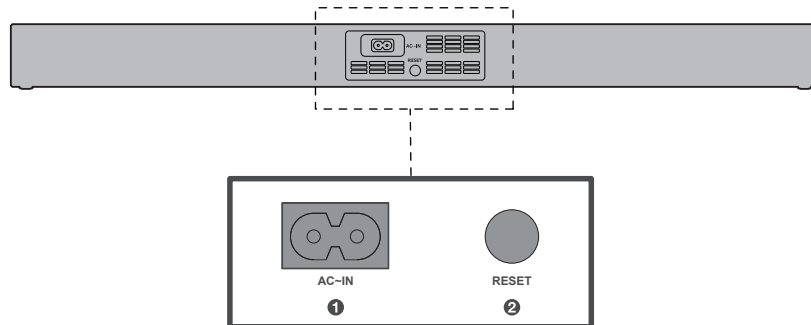

3b

Soundbar LED light



LED Expression	Product State	Color
Solid	Powered On	White
	Setup (waiting)	
	Booting up	
	Ready	
Blinking	Setup (working)	
	Working / Busy	
	Looking for Roku TV™	
	Software Update	
Solid moving to a slow blink	Restart	
Blink 3 times, then solid moving to a slow blink	Factory Reset	

4a

Position your soundbar

The ideal place to position the soundbar is centered underneath your Roku TV.

We also recommend moving the soundbar as close to the edge of the stand as possible, for better sound.

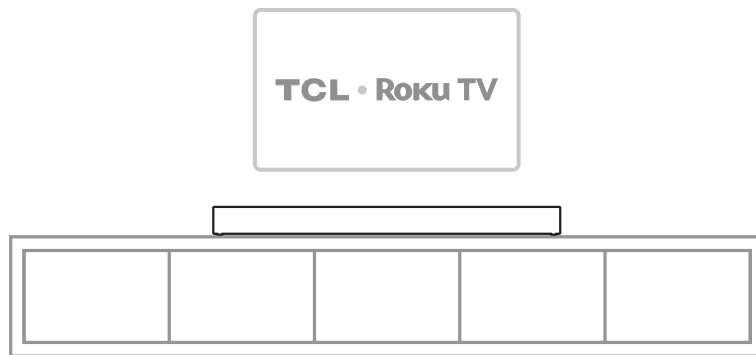

4b

Wall mount your soundbar

Required tools:



- 1 Place the supplied wall mount template on the wall. Make sure the wall mount template is at least 2 inches below the center of the Roku TV.
- 2 Use a level to make sure the wall mount template is positioned accurately.
- 3 Use the tape to stick the wall mount template firmly on the wall.
- 4 Mark on the wall using each marking on the template through the mounting holes.
- 5 Take away the wall mount template.
- 6 Drill a screw hole at each marking on the wall.

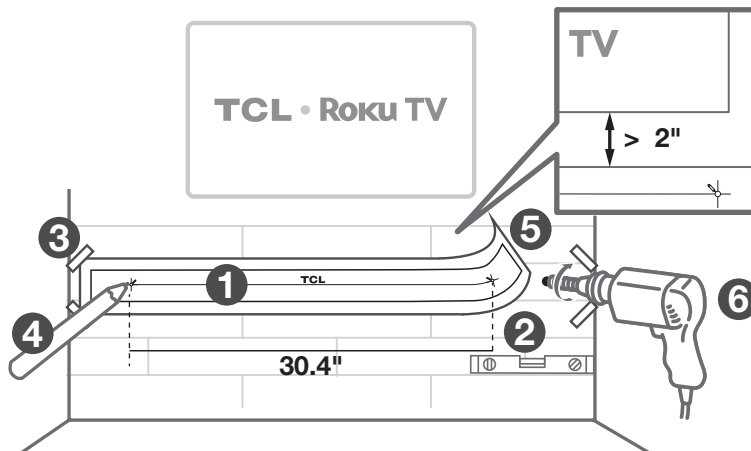

4b

Wall mount your soundbar

Required tools:



- 7 Insert the supplied wall anchors into 2 screw holes on the wall.
- 8 Insert the supplied wall bracket screws through the wall brackets into the wall anchors.
- 9 Fix and tighten the wall bracket screws on the wall.

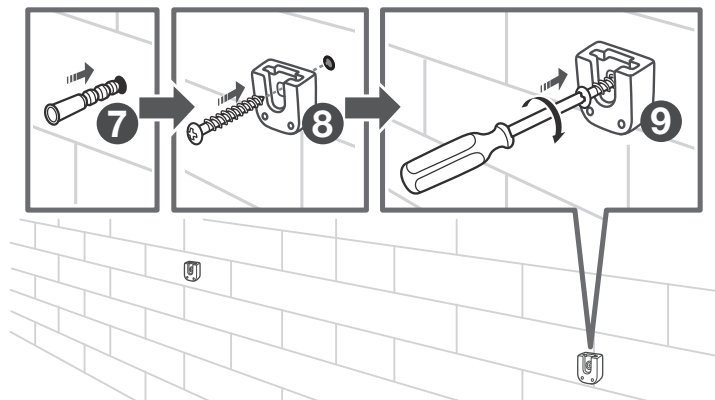

Required tools:



- 10 Unscrew the screws from the back of the soundbar and set them aside for potential use in the future.
- 11 Tighten the supplied wall mounting screws into the screw holes in the back of the soundbar.

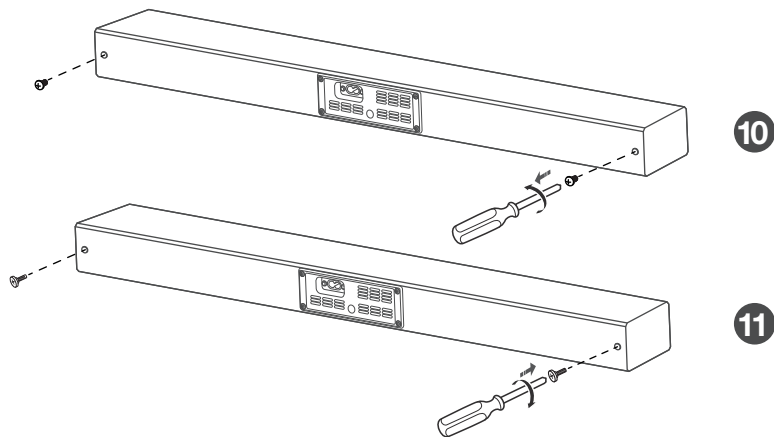

4b

Wall mount your soundbar

- 12 Hang the soundbar on the wall mount brackets.

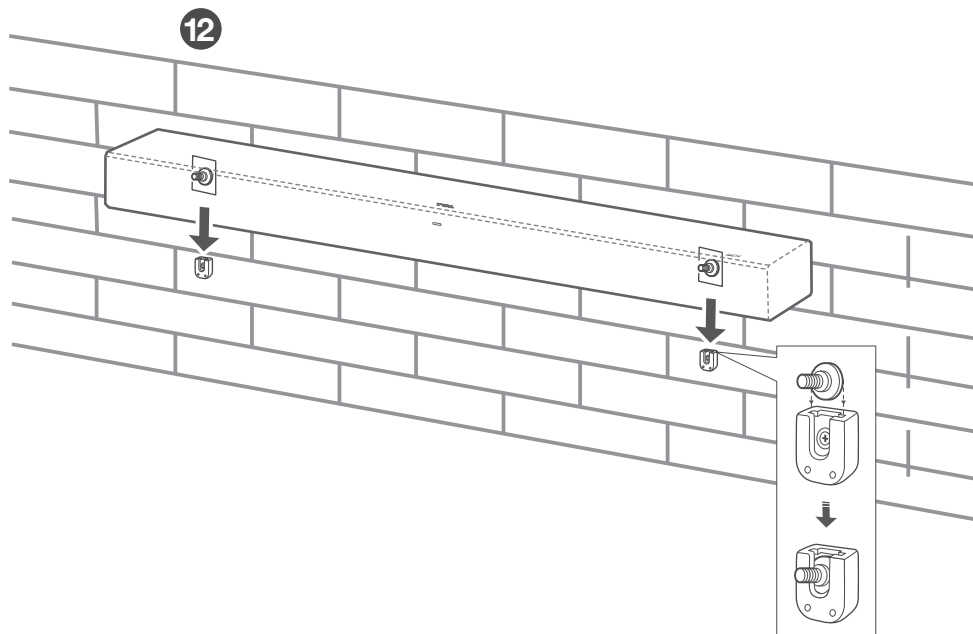

5

Connect to your Roku TV

What you'll need:

- Roku TV connected to the internet.
- Your Roku TV remote.

Let's get started:

- 1 Power up your soundbar.
- 2 Press and hold  on your Roku TV remote for 5 seconds to open the setup menu.

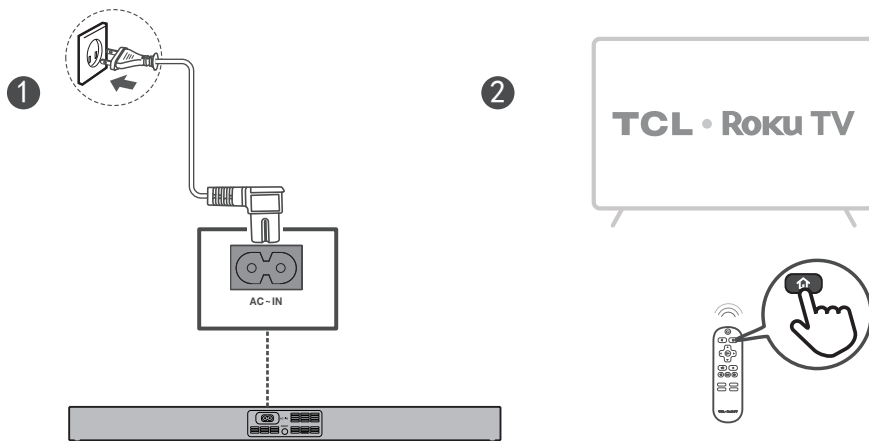

5

Connect to your Roku TV

- Follow the on-screen setup. Choose Wireless soundbar and select Continue to begin the pairing process.

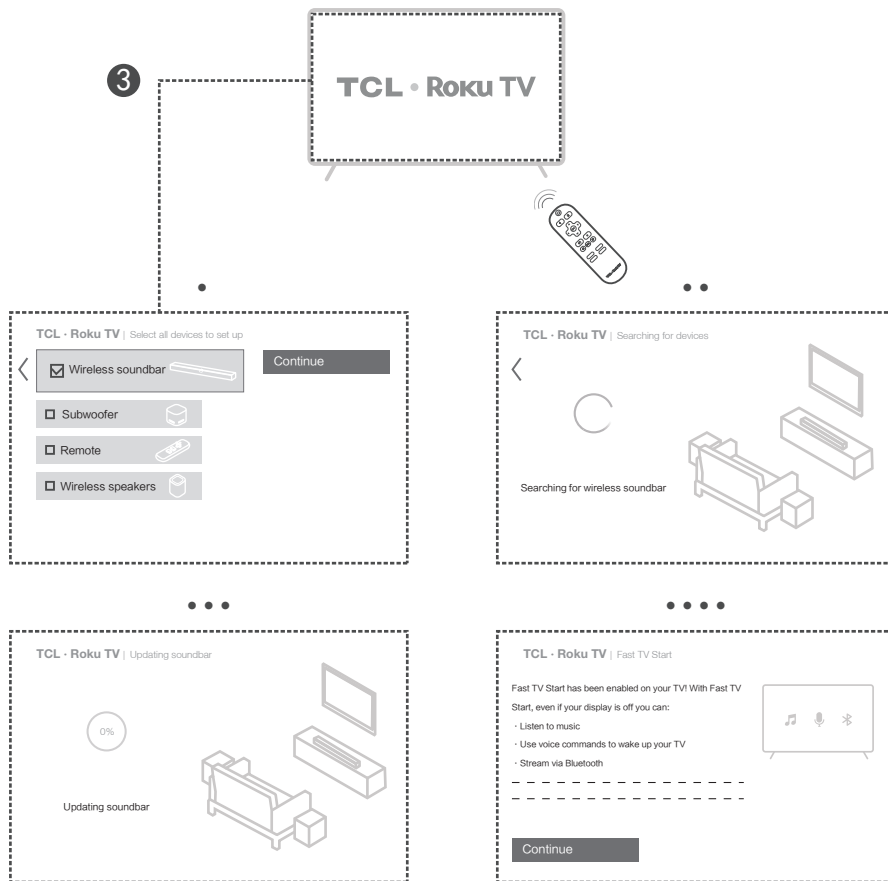

6

Pair with your Bluetooth® device

You can stream music from your mobile device via Bluetooth.

Make sure your soundbar is connected to your TV before you start. (Refer to section 5)

- Press the Home button  on your Roku remote.
 - Select Settings, followed by Remotes & devices.
 - Select Pair Bluetooth device.
 - When you see the Bluetooth pairing screen, go to your smartphone, tablet, or computer and follow the next several steps.
- > Open Bluetooth settings on your smartphone, tablet, or computer.
- > Wait a moment for your Bluetooth device to scan for devices and discover your Roku TV.
- > Select your Roku TV from the list of available devices.
- Pairing is successful.

A Bluetooth device (phone, tablet, etc.) only needs to follow the pairing process once.

Once it's been paired, you can reconnect any time by choosing the Roku TV from the list of Bluetooth devices on your smart phone, tablet, etc.

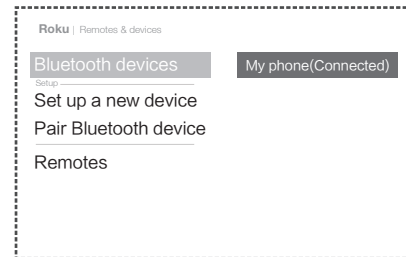
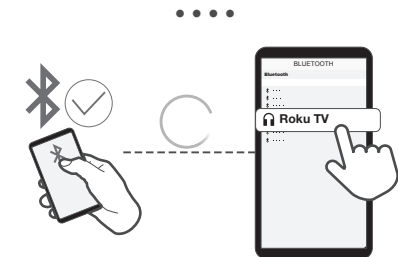
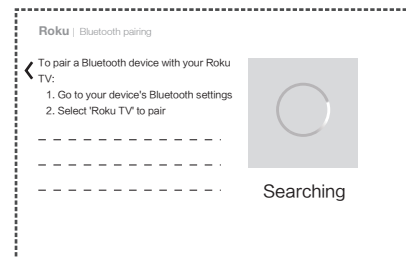
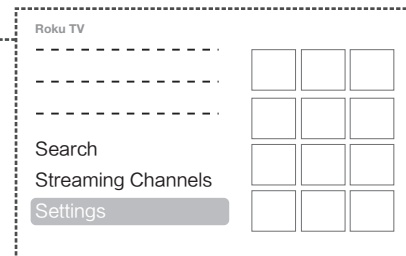
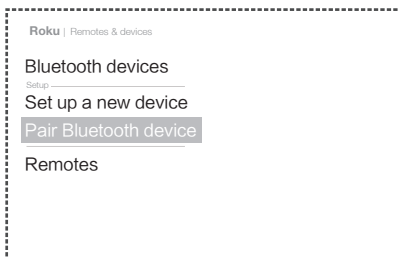
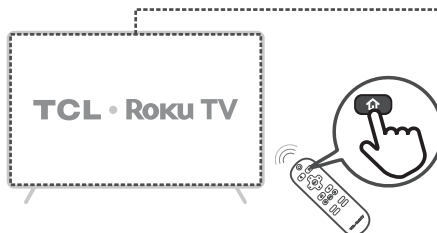

FAQ

Does this soundbar work with any TV?

No, the soundbar is only compatible with Roku TV. All Roku TVs will have a "Roku TV" logo in the lower right corner of the TV bezel and the home screen of the TV will say Roku TV.

Does this soundbar work with other Roku streaming players or wireless devices at the same time?

No, the soundbar and other Roku wireless devices are mutually exclusive.

How to use sound settings?

- While streaming video or music, press  .
- Select Sound Settings.
- Turn on the settings you want.

How to turn off the LED light of soundbar on your Roku TV?

- Press the Home button  on your Roku TV remote.
- Settings > System > Power.
- Follow the on-screen setup to turn off Standby LED.

* All technology names mentioned are the trademarks or registered trademarks of their respective companies.

DO NOT RETURN TO STORE

**WE ARE
READY TO
HELP** contact us first
with any questions

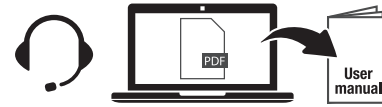

TCL SUPPORT:
support.tcl.com
1-877-300-9223



**TAKE CARE WHEN
REMOVING THE SOUNDBAR**



The Bluetooth® word mark and logos are registered trademarks owned by Bluetooth SIG, Inc. and any use of such marks by TTE Corporation is under license. Other trademarks and trade names are those of their respective owners.



Roku and Roku TV are the trademarks or registered trademarks of Roku, Inc.